

BOSE[®]



Acoustimass[®] 5 series V
Acoustimass[®] 3 series V
stereo speaker system

Owner's Guide | Brugervejledning | Bedienungsanleitung | Gebruikershandleiding | Guía del propietario | Käyttöohje
Notice d'utilisation | Manuale di istruzioni | Kezelési útmutató | Podręcznik użytkownika | Manual do proprietário | Bruksanvisning

Regulatory Information



This symbol means the product must not be discarded as household waste, and should be delivered to an appropriate collection facility for recycling. Proper disposal and recycling helps protect natural resources, human health and the environment. For more information on disposal and recycling of this product, contact your local municipality, disposal service, or the shop where you bought this product.



Bose Corporation hereby declares that this product is in compliance with the essential requirements and other relevant provisions of Directive 1999/5/EC and all other applicable EU directive requirements. The complete declaration of conformity can be found at: www.Bose.com/compliance.

Names and Contents of Toxic or Hazardous Substances or Elements						
Part Name	Toxic or Hazardous Substances and Elements					
	Lead (Pb)	Mercury (Hg)	Cadmium (Cd)	Hexavalent (CR(VI))	Polybrominated Biphenyl (PBB)	Polybrominated diphenylether (PBDE)
PCBs	X	0	0	0	0	0
Metal parts	X	0	0	0	0	0
Plastic parts	0	0	0	0	0	0
Speakers	X	0	0	0	0	0
Cables	X	0	0	0	0	0
0: Indicates that this toxic or hazardous substance contained in all of the homogeneous materials for this part is below the limit requirement in SJ/T 11363-2006.						
X: Indicates that this toxic or hazardous substance contained in at least one of the homogeneous materials used for this part is above the limit requirement in SJ/T 11363-2006.						

Please complete and retain for your records.

The serial numbers are located on the connector panel of the Acoustimass® module.

Serial Number: _____

Model Number: _____

Purchase date: _____

Please keep your receipt together with this owner's guide.

Introduction

About your Bose® Acoustimass® stereo speaker system 4
 System features 4
Unpacking the system 4

Setting Up

Placement guidelines 5
 Sample system placement 5
Connecting the speakers to the Acoustimass module 6
Mounting the speakers 6
Connecting the Acoustimass module to your receiver or amplifier 7
 Before plugging in your receiver or amplifier 7
Checking the system 7
Understanding automatic system protection 7

Care and Maintenance

Troubleshooting 8
Cleaning 8
Customer service 8
Limited warranty 8
Accessories 8

Technical information

Compatibility 9
Wire recommendations 9

Introduction

About your Bose® Acoustimass® stereo speaker system

The Bose Acoustimass stereo speaker system delivers spacious, true sound from small, high-performance speakers for consistent audio performance regardless of content, source or room layout.

System Features

- Bose Acoustimass speaker technology delivers full, natural audio performance.
- Hideaway Acoustimass module provides impactful bass sound.
- Speakers can be mounted on the wall, table stands or floor stands (kits available separately).

Unpacking the system

Carefully unpack the carton and confirm that the following parts are included:



WARNING: This product contains magnetic material. Contact your physician if you have questions on whether this might affect the operation of your implantable medical device.

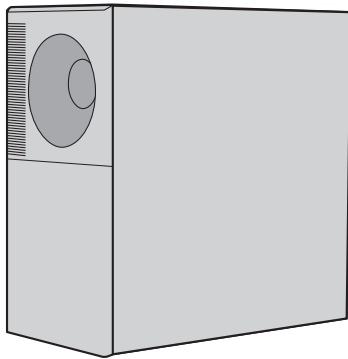

Acoustimass module



Rubber feet

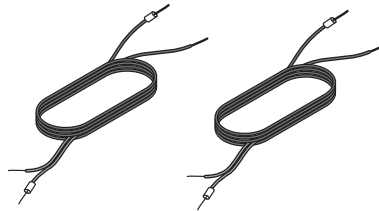

(2) speaker wires

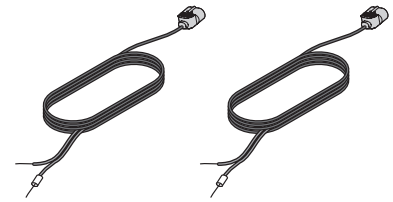

(2) speaker cables

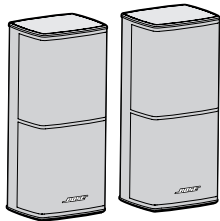

Acoustimass 5 system

(2) Direct/Reflecting® series II speakers



Acoustimass 3 system

(2) Virtually Invisible® series II speakers

Note: If part of the system is damaged, do not use it. Contact your authorized Bose dealer or Bose Customer Service. Refer to the contact sheet in the carton.

Placement guidelines

Place the system outside of and away from metal cabinets, other audio/video components and direct heat sources.

Acoustimass® Module	<ul style="list-style-type: none"> • Stand the module on its rubber feet along a wall within 5 ft. (1.5 m) of the corner. To increase bass, move the module closer to a corner. • Choose a stable and level surface. Vibration can cause the module to move, particularly on smooth surfaces like marble, glass or highly polished wood. • Leave at least 2 in. (50 mm) of space between the opening and the wall. • Place at least 2 ft. (0.6 m) from any TV to avoid magnetic interference with the TV image. Move it farther away if you still notice interference.
Speakers	<ul style="list-style-type: none"> • Place the speakers 3 - 15 ft. (1- 4.6 m) apart. • Place the speakers at least 6 in. (.15 m) away from any CRT (picture tube) TV.

Sample system placement

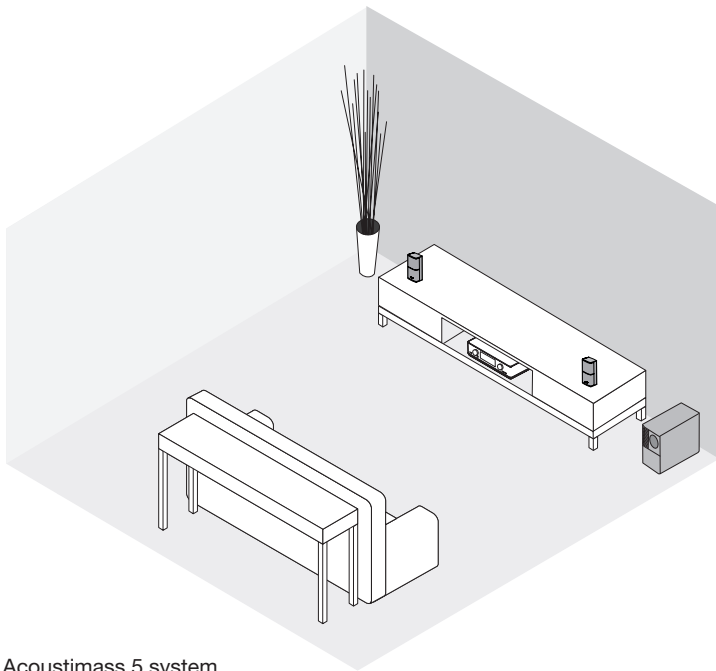

Acoustimass 5 system

Note: Attach the rubber feet to the Acoustimass module to protect your floor.

CAUTION: Do not place the Acoustimass module on its front or back panel when in use.

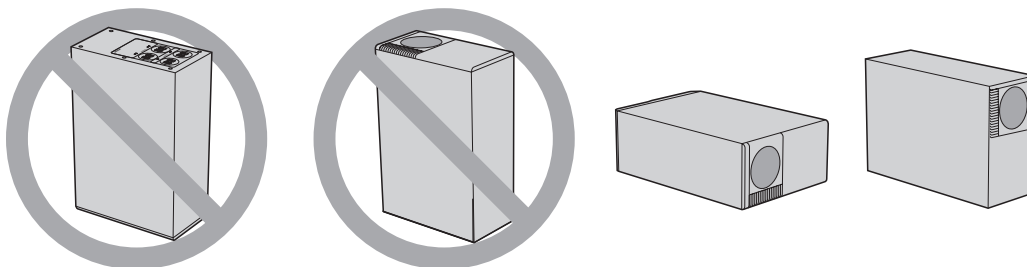

Setting Up

Connecting the speakers to the Acoustimass module

Use the two provided speaker cables to connect your speakers to the Acoustimass module.

CAUTION: Turn off and unplug all components before making the connections.

1. Insert the left speaker cable's **L** plug into the left speaker, with the label facing down.
2. Insert the right speaker cable's **R** plug into the right speaker, with the label facing down.

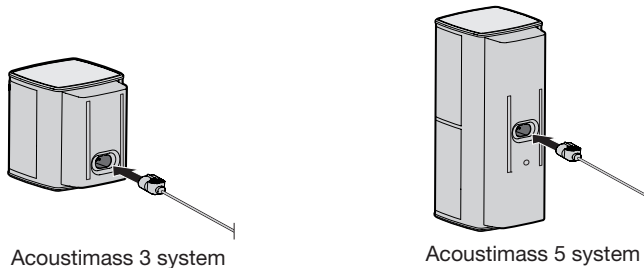

Acoustimass 3 system

Acoustimass 5 system

CAUTION: Do not connect your amplifier or receiver directly to the speakers. Connect the speakers to the Acoustimass module to avoid damaging your system.

3. Connect the other end of the left speaker cable to the **L** (left) **OUTPUTS TO CUBE SPEAKERS** terminal on the connector panel of the Acoustimass module.
 - A. Insert the marked wire into the positive (+) terminal (with the red marking).
 - B. Insert the unmarked wire into the negative (-) terminal (with the black marking).
4. Repeat step 3 for the right speaker cable, connecting its wires to the **R** (right) terminal.

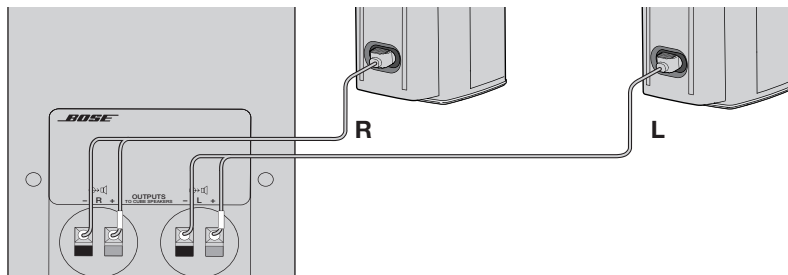

Mounting the speakers

You can place system speakers on wall brackets, table stands or floor stands. You can also use additional speaker wire and a Bose connector to increase the distance between the speakers and the Acoustimass module. To purchase these accessories, contact your local Bose dealer or visit www.Bose.com

CAUTION: Do not use any other hardware to mount the speakers.

Connecting the Acoustimass® module to your receiver or amplifier

The speaker wires without plugs connect the Acoustimass module to your receiver or amplifier. Your speaker system works with receivers or amplifiers rated from 10 to 200 watts per channel with 4 to 8 ohm impedance. Refer to your receiver or amplifier owner's guide.

CAUTION: Incorrect wiring results in little or no bass output and could damage the system.

1. Connect the speaker wires to the **INPUTS FROM AMP OR RECEIVER** terminals on the Acoustimass module's rear panel:
 - A. Connect the marked wire to the positive (+) terminal of the **L** (left) pair of input terminals.
 - B. Connect the unmarked wire to the negative (-) terminal of the **L** (left) pair of input terminals.
 - C. Repeat steps **A** and **B** with the other speaker wire for the **R** (right) pair of input terminals.

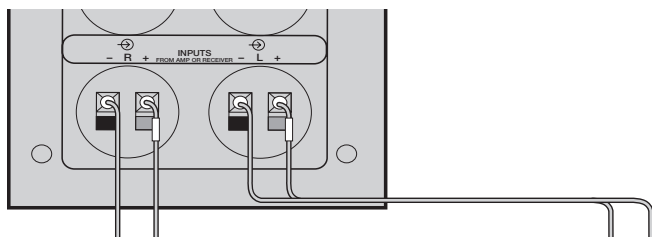

2. Connect the other ends of the cables to the speaker terminals of your amplifier or receiver.
 - A. Connect the marked wire connected to the **L** (left) pair of input terminals on the module to the **LEFT** positive (+) terminal on your amplifier or receiver.
 - B. Connect the unmarked wire connected to the **L** (left) pair of input terminals on the module to the **LEFT** negative (-) terminal on your amplifier or receiver.
 - C. Repeat steps A and B with the wire connected to the **R** (right) pair of input terminals on your Acoustimass module and the **RIGHT** pair of input terminals on your amplifier or receiver.

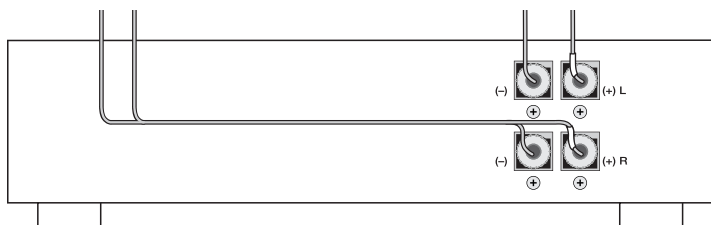

Before plugging in your receiver or amplifier:

- Ensure no strands of wire from any terminal are brushing against any other terminal. Such “bridged” wires create short circuits which can damage your receiver or amplifier.
- Check all connections to avoid damaging your speakers. Make sure the speakers are connected to the module and not directly to the amplifier or receiver.

Checking the system

With your amplifier and Acoustimass® module powered, your system should respond accordingly:

- With the balance control on your amplifier turned to the left, sound comes from the Acoustimass module and left speaker only.
- With the balance control turned to the right, sound comes from the Acoustimass module and right speaker only.
- With the balance control in the center position, music with bass should be the same or louder with the control in the center than to the left or right.

If your system does not respond as described, check all the wires for proper positive to positive and negative to negative connections. If your system still doesn't respond properly, see “Troubleshooting” on page 8.

Understanding automatic system protection

When played at high volume, your Acoustimass systems' automatic protection circuit activates to prevent damage to the system from electrical stress or overload. When this happens, you may notice a slight decrease in volume. This indicates that the power input may have exceeded safe levels. Setting the volume at or above this level for sustained periods is not recommended.

Care and Maintenance

Troubleshooting

Problem	What to do
Distorted or no sound	<ul style="list-style-type: none">• Disconnect the amplifier or receiver from the system, and reconnect the Acoustimass® module to another amplifier or receiver that is working properly. If the system now works, the problem is in your amplifier or receiver.• Power off the amplifier or receiver and check all the connections between the speakers, the module, and amplifier or receiver.• Refer to your amplifier or receiver's owner's guide for more troubleshooting information.• See "Checking your receiver or amplifier's speaker channels".

Checking your receiver or amplifier's speaker channels

If one of the speakers does not play or sounds distorted, your amplifier or receiver's speaker channel may be defective.

1. Disconnect both speaker cables from the amplifier or receiver.
2. Reconnect the cable from the Acoustimass® module's **L INPUTS** to the amplifier or receiver's right speaker terminals.
3. Disconnect both speaker cables from the amplifier or receiver. Reconnect the cable from the Acoustimass® module's **L INPUTS** to the amplifier or receiver's right speaker terminals.
4. Set the amplifier or receiver's balance control all the way to the right and power it on. If the left speaker now plays properly, your amplifier or receiver's left speaker channel may be defective.
5. Repeat to check your right speaker, reconnecting the cable from the module's **R INPUTS** to the amplifier or receiver's left speaker terminals.

CAUTION: DO NOT connect the other speaker to the potentially defective channel. If the channel is defective, it could damage your Acoustimass system.

Cleaning

- Clean the surface of the system with a soft, dry cloth.
- Do not use any sprays near the system. Do not use any solvents, chemicals, or cleaning solutions containing alcohol, ammonia or abrasives.
- Do not allow liquids to spill into any openings.
- You can vacuum the speaker grilles. To avoid damaging the drivers located directly behind the grille, use light pressure only.

Customer service

For additional help, contact Bose® Customer Service. Refer to the contact sheet in the carton.

Limited warranty

Your system is covered by a limited warranty. Details of the limited warranty are provided on the product registration card that is in the carton. Please refer to the card for instructions on how to register. Failure to register will not affect your limited warranty rights.

The warranty information provided with this product does not apply in Australia or New Zealand. See our website at www.bose.com.au/warranty or www.bose.co.nz/warranty for details of the Australia and New Zealand warranty.

Compatibility

Compatible with receivers or amplifiers rated from 4 – 8 ohms

Compatible with receivers or amplifiers rated from 10 – 100 watts per channel

IEC rating: 50 watts per channel

Wire recommendations

Based on maximum frequency response deviation of ± 0.5 dB.

Gauge	Length
18 (0.75 mm ²)	30 ft (9 m) maximum
16 (1.5 mm ²)	45 ft (14 m) maximum